

MG/500G

The MG/500G is a plugready cooling cabinet with 2 glassdoors. In the cabinet are shelves for the storage of cans or bottles. Silver skin plate is used for the interior of the cabinet. For the exterior, anthracite coloured skin plate is used. Illumination is mounted in the door post. The glassdoor is double glazed and full length.

Capillary	1,2mm lenght= 2600mm
Compressor	GL90PB(8,8cc)
Condenser	STN 7321
Fan motor condenser	5 Watt
Fan wing condenser	Alu Ø 200mm sucking
Cooling capacity	463 Watt*
Power consumption	400 Watt*
Dimensions exterior WxDxH	920x535x1800mm
Evaporator	Finned Aluminium
Fan motor evaporator	2xØ120mm
Finish interior	silver skin plate
Finish exterior	anthracite skin plate
Insulation	polyurethane foam 25mm
Internal volume	500ltr. / 508x30cl bottles.
Refrigerant	R134A
Condensate evaporator	120/300 Watt
Temperature range	+2°C/+12°C
Thermostat	XR02CX
Defrost / drain	Automatic / evaporation
Voltage range	220-240V/ 50 Hz
Illumination	1x36Watt
Weight (unpacked)	145KG

* = Conditions: $T_e = -5^{\circ}\text{C}$, $T_c = 45^{\circ}\text{C}$, ambient $= 25^{\circ}\text{C}$



Gamko

MG/500G

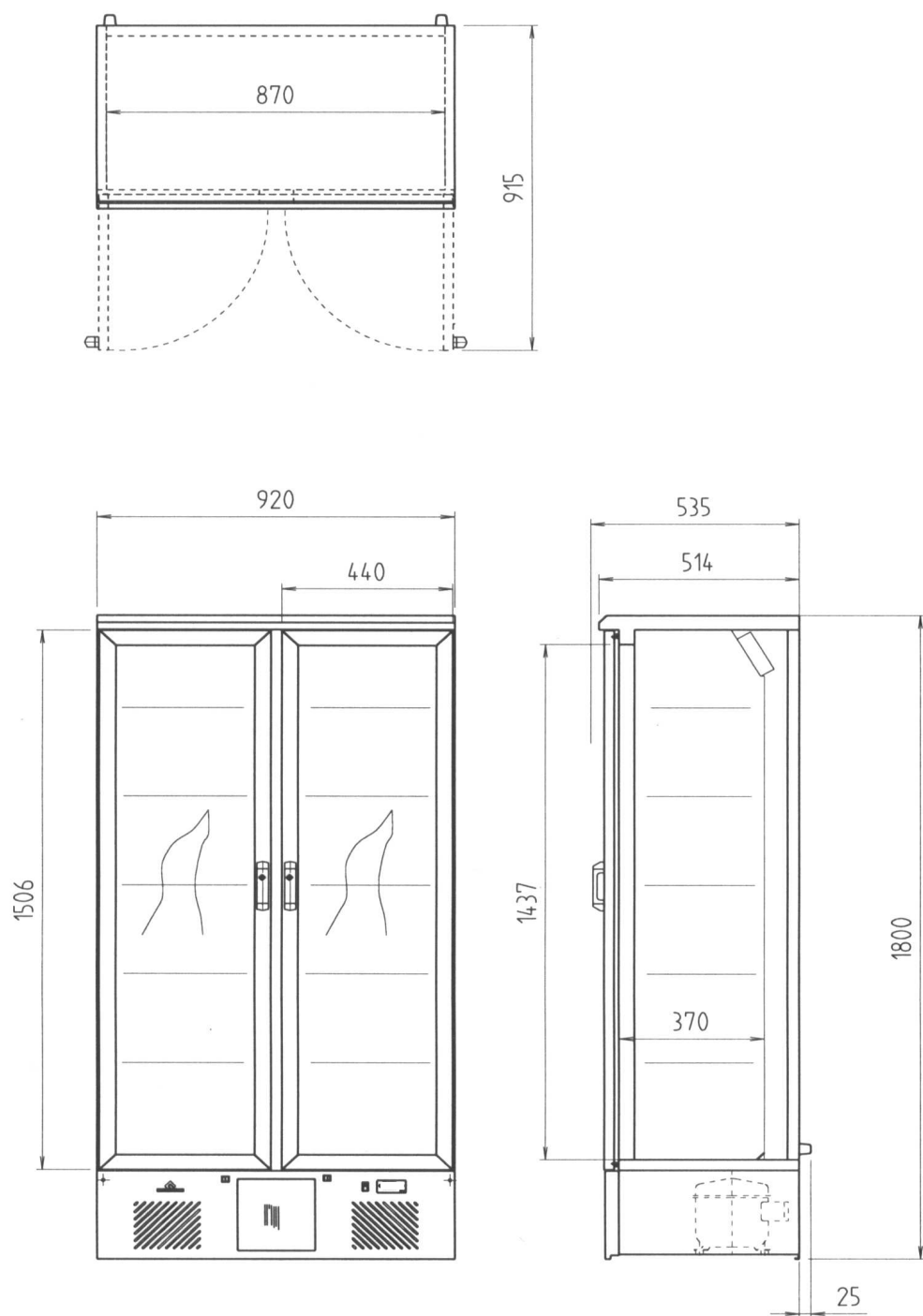

Gamko

MG/500G

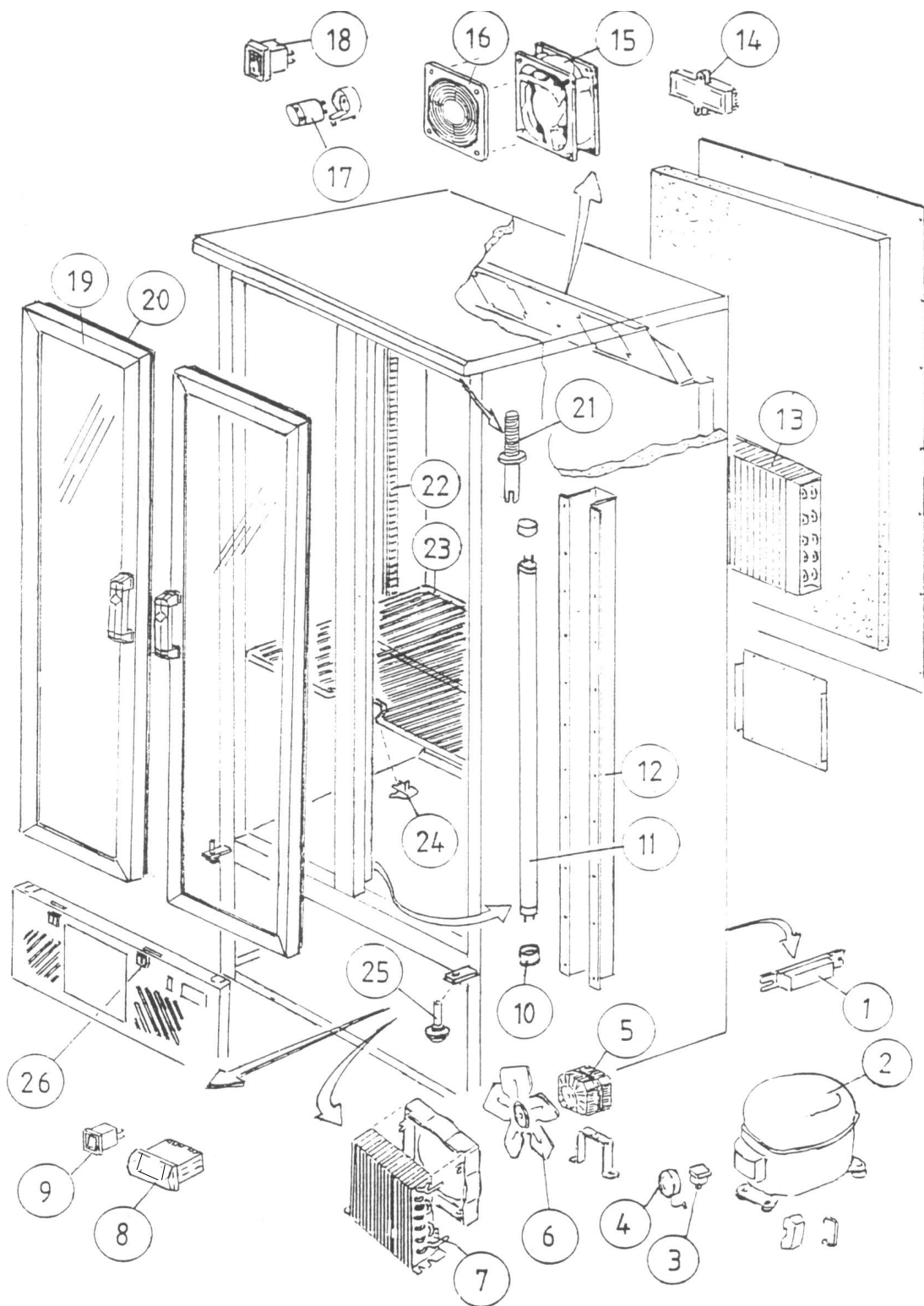

Gamko

MG/500G

NR	PARTS	CODE
1	block switch	008090333
2	compressor GL90PB	001020157
3	startrelais	001050148
4	clixon	001010121
5	fanmotor	007030243
6	fanwingØ200 sucking	007030302
7	Condenser STN7321	002010104
8	thermostat	005050168
	sensor	005050332
9	light switch	008040127
10	tube connections	008090337
11	fluorescent tube 36w	008090206
12	tube cover	255011A
13	evaporator	002030181
14	junction box	008010418
15	fanmotor(interior)	007030229
16	fanmotorgrid	007030107
17	starter	008090323
18	switch on/off	008040101
19	door	MAXI-FR500LG MAXI-FR500RG
20	door gasket	006110499
21	upper door hinge	013040034
22	shelf climbing strip	251125BE
23	shelf	004010366
24	shelf support clip	013010001
25	lower door hinge	013040040
26	lock	013050257 + 013050264
	Unit	214382D



Gamko

MG/500G

Nr.	date	modification			Reg.Nr.	
1						

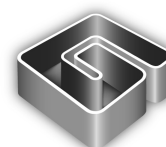

Gamko